



Slade End, Epping, CM16

BUTLER & STAG



Guide Price £325,000 - £350,000

We are delighted to offer this beautifully presented one bedroom ground floor maisonette, ideally situated close to Theydon Bois Central Line Station, providing excellent transport links into Central London.



Freehold

- Ground Floor Maisonette
- One Bedroom
- Spacious Lounge
- Allocated Parking
- CHAIN FREE
- Close To Theydon Bois Station

This property is in exceptional condition throughout, with all rooms currently being re-painted to ensure a fresh and modern feel. The kitchen boasts fully fitted units and top-of-the-line appliances, perfect for any culinary enthusiast. The lounge is spacious providing a comfortable and stylish living area. The bedroom is a generously sized double, offering ample space for relaxation. The bathroom is also modern, featuring contemporary fixtures and fittings.

Additional benefits of this superb maisonette include ample storage space, efficient gas central heating, double glazing for added insulation and comfort, and allocated parking for two cars – a rare find in this sought-after location.





Slade End, CM16

Approx. Gross Internal Area 459 Sq Ft - 42.64 Sq M

BUTLER & STAG

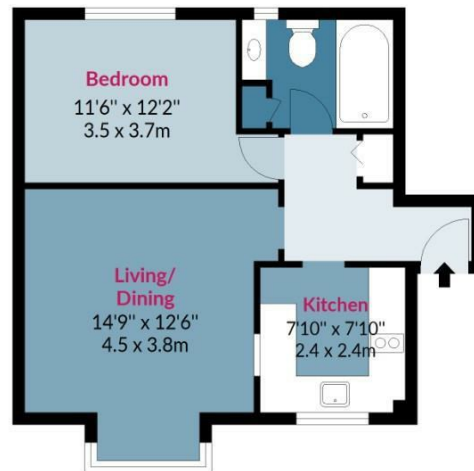

Ground Floor

Floor Area 459 Sq Ft - 42.64 Sq M



Measured according to RICS IPMS2. Floor plan is for illustrative purposes only and is not to scale. Every attempt has been made to ensure the accuracy of the floor plan shown, however all measurements, fixtures, fittings and data shown are an approximate interpretation for illustrative purposes only. 1 sq m = 10.76 sq feet.

lpaplus.com

Date: 6/20/2024

BUTLER & STAG

☎ 01992 667666

🏠 4 Forest Drive, Theydon Bois, Essex, CM16 7EY

✉ theydon@butlerandstag.com

www.butlerandstag.uk

IMPORTANT NOTICE - These particulars have been prepared in good faith and they are not intended to constitute part of an offer or contract. We have not performed a structural survey on this property and the services, appliances and specific fittings have not been tested. All photographs, measurements, floor plans and distances referred to are given as a guide and should not be relied upon.